

MIC 800W LED FLOOD LIGHT

LIGHT THE WORLD



ITEM No.: MFL-T800

Electrical Specifications

• Led Power	800w
• IP Grade	IP66
• Input Voltage	AC85-300V
• Operating Temperature	-40°C to +50°C
• Driver Brand	Meanwell driver 
• Power Factor (PF)	>0.95
• Driver Efficiency	>92%
• Certification	CE,ROHS,TUV,FCC,ETL/DLC

Photometric & Packing Specifications

• Led Lamp	USA CREE XHP50 	• Guarantee	5 years 
• Led Quantity	72pcs LEDs	• CCT	2700k~6500k
• Lumen Output	>80000LM	• CRI	>80
• Light Efficient	100lm/w	• NW/GW	23kg/24.5kg
• Beam angle	5/10/20/30/60°	• Product size	Dia472*496mm
• Life span	>50000 hours	• Carton size	630*530*450mm, 1pcs/CTN

Product size

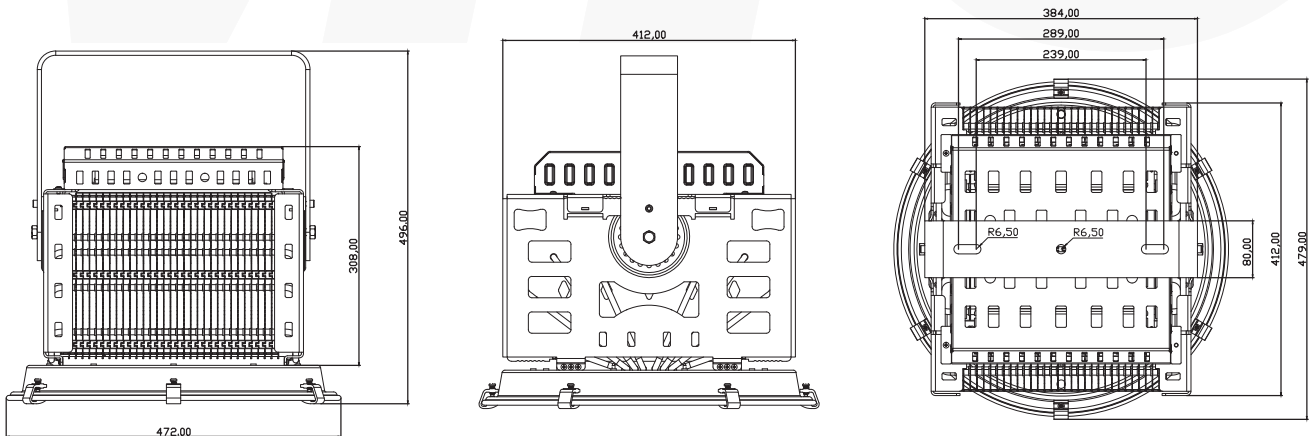

Reflector

5/10/20/30/60 degree beam angle reflector for optional, with surface polishing anodic oxidation treatment

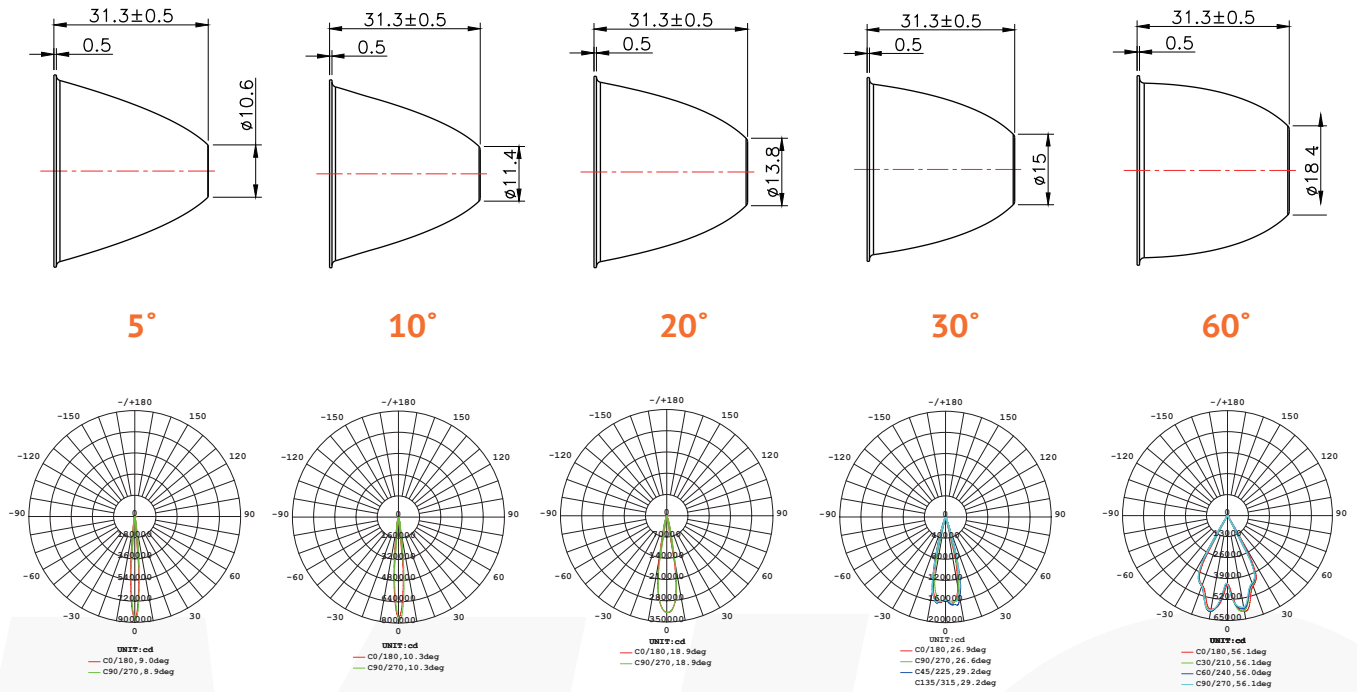

Product structure

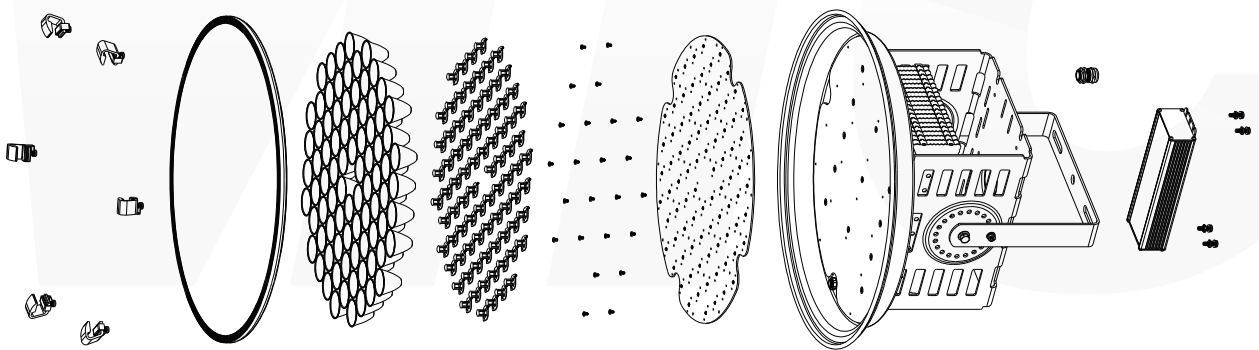

Warning

1. Please hire qualified person or professional installation company to install the light.
2. Please check the local voltage range is correspond with the working voltage of the light before installation.
3. Examine product carefully after open the carton. If it's damaged, please contact us.
4. Make sure the power supply has been cut off before maintenance or installation the lamp. After confirm the power cord is properly installed, the power can be turn on.
5. Make sure there is a good ventilation environment around the lamp. Keep the light out of fire, electrical shock or vibration.