

# MIC 300W LED FLOOD LIGHT

LIGHT THE WORLD



ITEM No.: MFL-T300

## Electrical Specifications

• Led Power	300w
• IP Grade	IP66
• Input Voltage	AC85-300V
• Operating Temperature	-40°C to +50°C
• Driver Brand	Meanwell driver 
• Power Factor (PF)	>0.95
• Driver Efficiency	>92%
• Certification	CE,ROHS,TUV,FCC,ETL/DLC

## Photometric & Packing Specifications

• Led Lamp	USA CREE XML2 	• Guarantee	5 years 
• Led Quantity	84pcs LEDs	• CCT	2700k~6500k
• Lumen Output	>30000LM	• CRI	>80
• Light Efficient	100lm/w	• NW/GW	10kg/11.5kg
• Beam angle	5/10/20/30/60°	• Product size	Dia369*356mm
• Life span	>50000 hours	• Carton size	440*440*330mm, 1pcs/CTN

## Product size

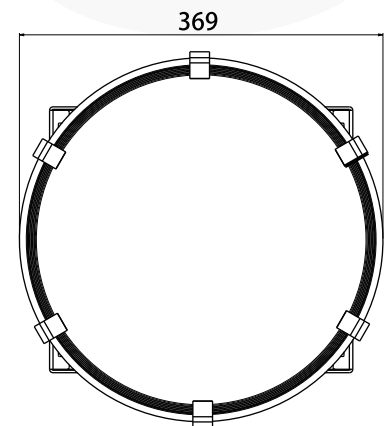
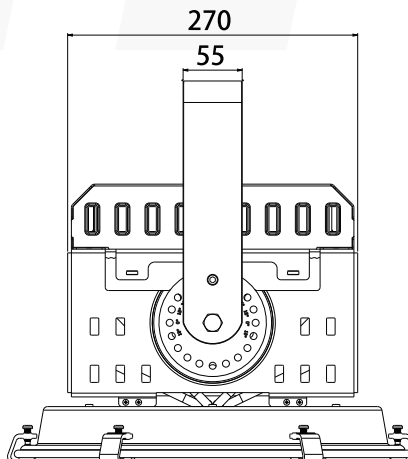
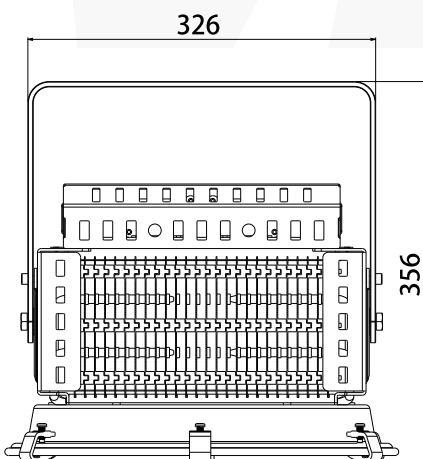

## Reflector

5/10/20/30/60 degree beam angle reflector for optional, with surface polishing anodic oxidation treatment

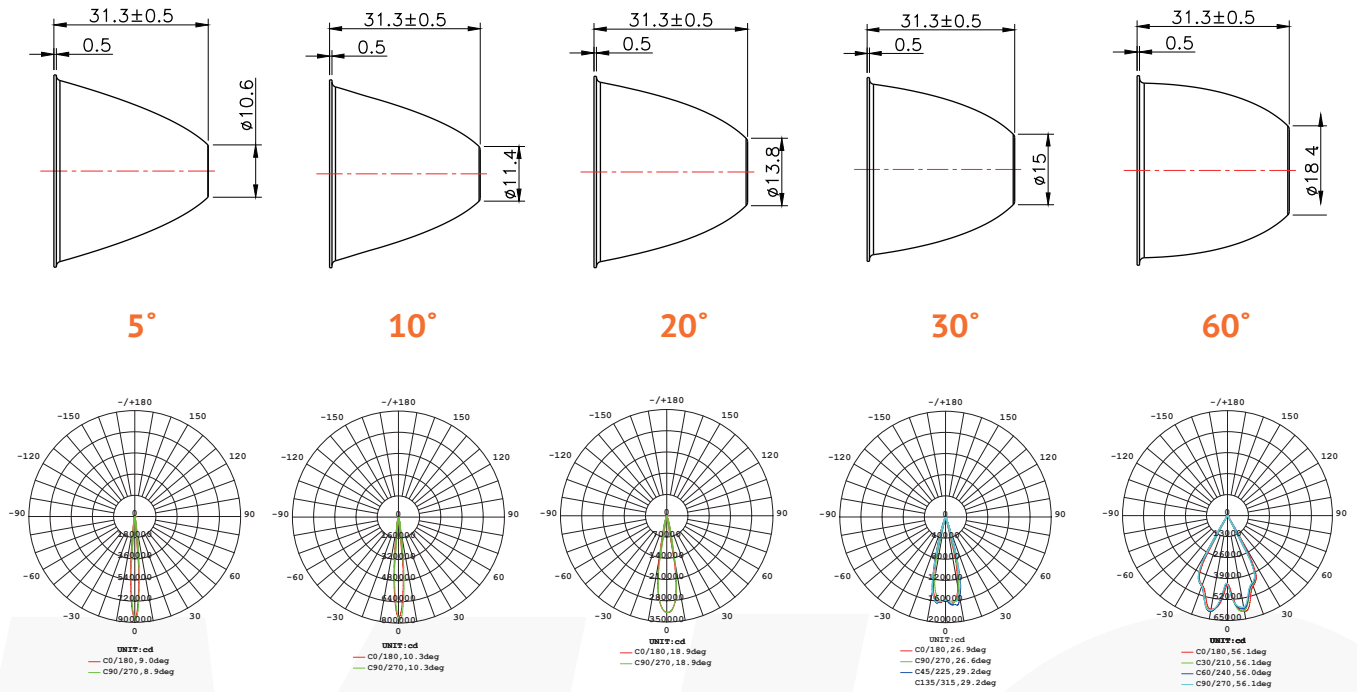

## Product structure

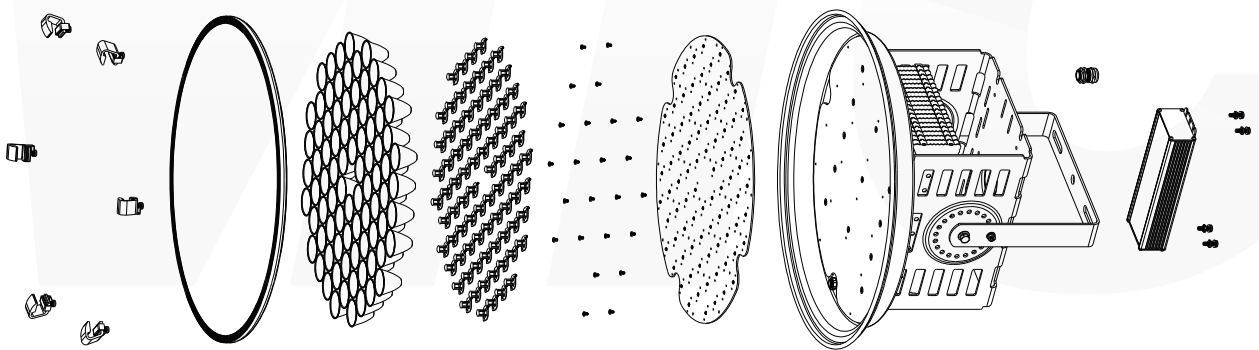

## Warning

1. Please hire qualified person or professional installation company to install the light.
2. Please check the local voltage range is correspond with the working voltage of the light before installation.
3. Examine product carefully after open the carton. If it's damaged, please contact us.
4. Make sure the power supply has been cut off before maintenance or installation the lamp. After confirm the power cord is properly installed, the power can be turn on.
5. Make sure there is a good ventilation environment around the lamp. Keep the light out of fire, electrical shock or vibration.